

(1) (2)
SMR Federal
Code Stock
Number

(3)
DESCRIPTION

TM9-2320-211-34P

(4) (5) (6)
UNIT of meas
of inc. allowance
Unit

(7)
allowance

(8) (9) (10)
alw maint
per alw

100 per (a) (b)
equip100 Figure Item
cnt- equipNo. No.

Reference Number & Mfr. Code

Usable On Code

(a) (b) (c) (a) (b) (c)
1-20 21-5(51-10(1-20 21-5(51-10(

1412-HYDRAULIC OR AIR CYLINDERS--CONTINUED

1-SPRING: 89-195 (46606) 107 9
2520-740-92 1-GASKET: 7409281 (19207) 107 10
5330-735-13 1-PACKING: 7351367 (19207)
1-PACKING: 546875 (21450)

1413-TANKS AND RESERVOIRS

Code	SMR Federal Code Stock Number	Description	Usable On Code	Unit	(4)	(5)	(6)	(7)	(8)	(9)	(10)
P-O	2520-740-92	RESERVOIR, OIL: HYDRAULIC STEERING 7409290 (19207)	A	EA	1	*	*	*	*	6	20 106 1
P-O	4730-042-63	PLUG, PIPE: OIL DRAIN 444697 (21450)	A	EA	1	*	*	*	*	4	5 106 2
X1		BODY: 10883503 (19207)	A		1						106 3
P-O	2590-786-01	BREATHER ASSEMBLY, FILTER: 8376371 (19207)	A	EA	1	*	*	*	*	6	20 106 4
P-O	2520-177-92	SCREEN, OIL RESERVOIR: 10883443 (19207)	A	EA	1	*	*	*	*	6	20 106 5
P-O	5365-281-66	RING, RETAINING: SCREEN 5298689 (19207)	A	EA	1	*	*	*	*	6	20 106 6
P-O	5330-359-04	GASKET: FILLER PLUG 5283976 (19207)	A	EA	1	*	*	*	*	15	30 106 7
P-O	4730-575-26	PLUG, MACHINE THREAD 10883350 (19207)	A	EA	1	*	*	*	*	4	5 106 8
P-O	4730-045-97	PLUG, PIPE: MS49006-6 (96906)	A	EA	1	*	*	*	*	4	5 106 9
P-O	5305-269-28	SCREW, CAP, HEXAGON: MS90726-59 (96906)	A	EA	2	*	*	*	*	6	10 106 10
P-O	5310-080-60	WASHER, FLAT: MS27183-14 (96906)	A	EA	4	*	*	*	*	6	10 106 11
P-O	5310-950-00	NUT, SELF-LOCKING: MS21044N6 (96906)	A	EA	2	*	*	*	*	6	10 106 12
P-O	5305-269-28	SCREW, CAP, HEXAGON: MS90726-65 (96906)	A	EA	1	*	*	*	*	6	10 106 13
P-O	5310-383-41	WASHER, FLAT: 52803V (31007)	A	EA	1	*	*	*	*	6	10 106 14
X2-O		CUSHION: 102735R1 (31007)	A	EA	2	*	*	*	*		106 15
X2-O		SPACER: 102413R1 (31007)	A	EA	1	*	*	*	*		106 16

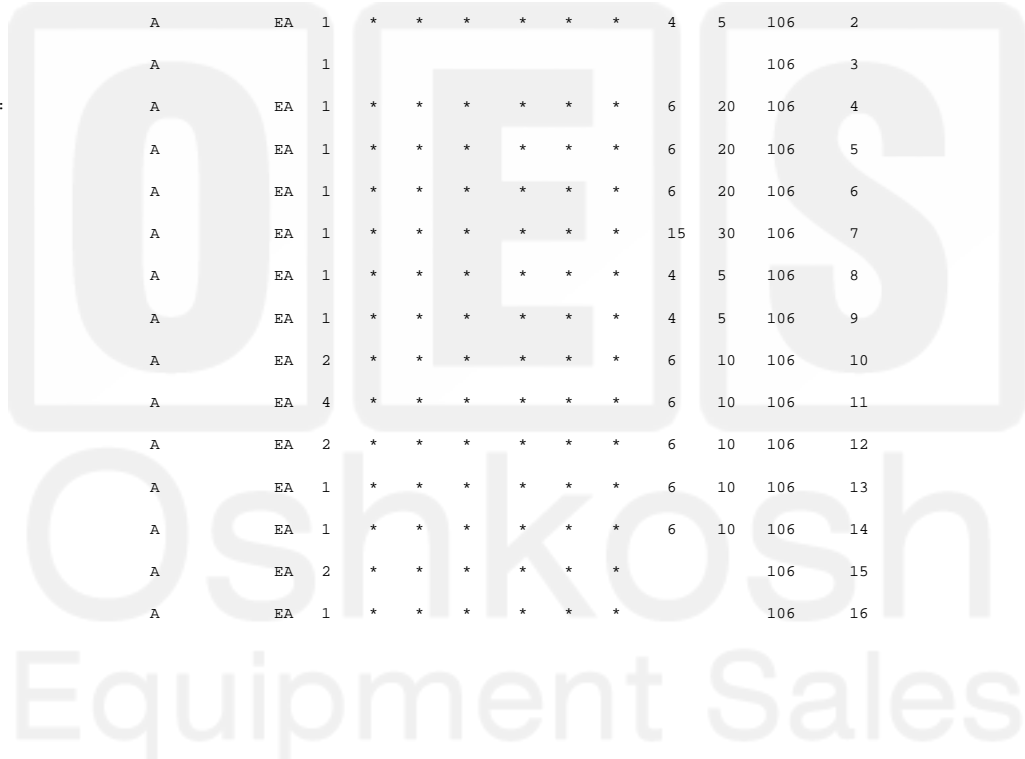

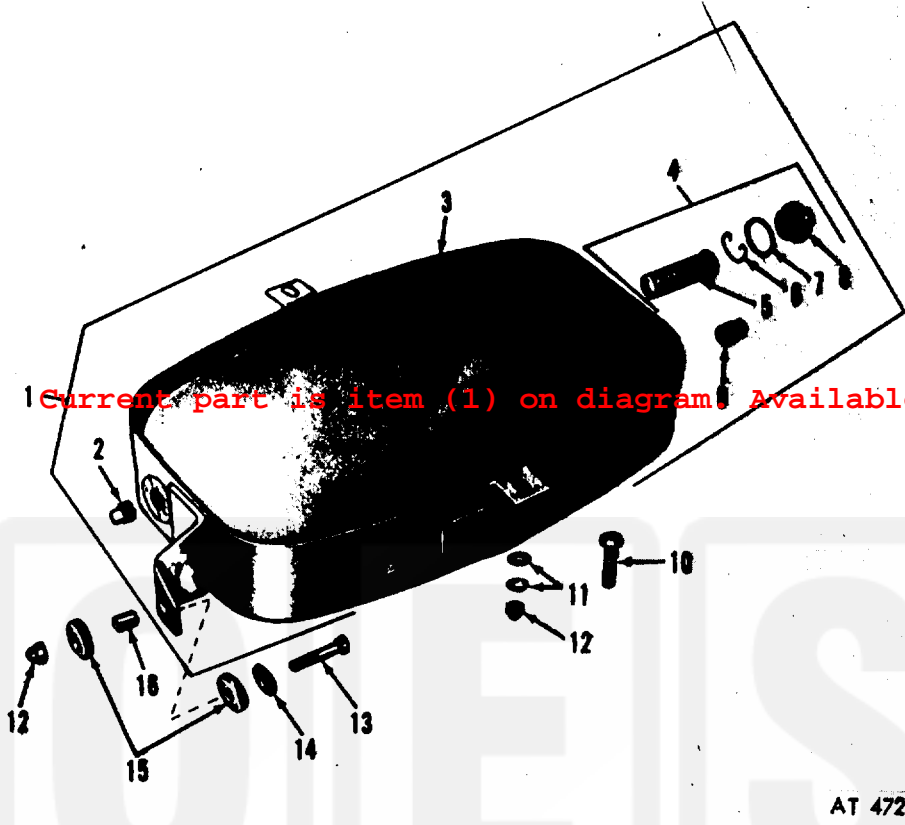

Figure 106. Reservoir assembly and related parts.

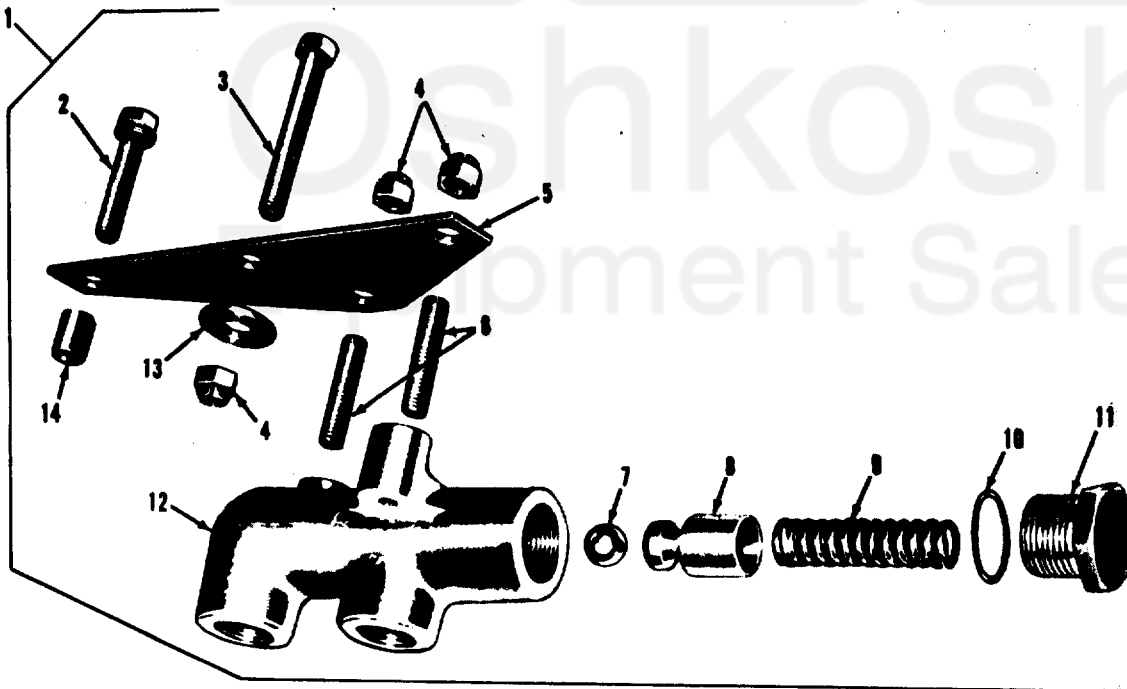

Figure 107. Relief valve assembly (component of figure 102).